

DBT Soft Close Drawer System

Module Box Assembly Instructions



Special Features

- Length 270, 350,400,450,500. The drawer side board is 88mm high
- The drawer width can be designed freely with automatic error adjustment
- Hidden full pullout silencing sliding skid can bear 30Kg and enjoys excellent stability and quiet and smooth sliding performance
- Quick installation and dismantle
- Newly-designed built in damper is free from reinstallation and ensures soft and smooth drawer movements.

Basic length	Internally usable drawer depth	Minimum installation depth of drawer	Minimum installation height
270mm	244mm	270mm	105mm
350mm	324mm	350mm	105mm
400mm	374mm	400mm	105mm
450mm	424mm	450mm	105mm
500mm	474mm	500mm	105mm

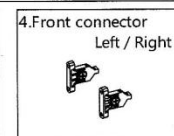
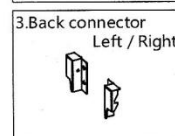
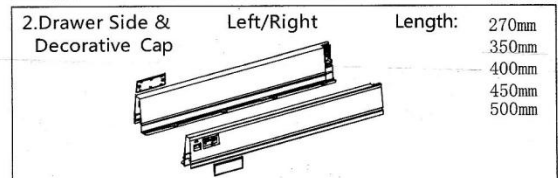
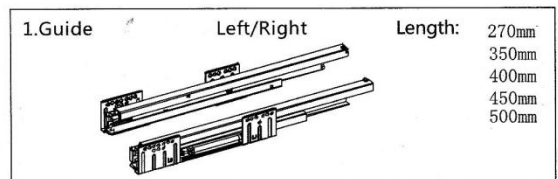
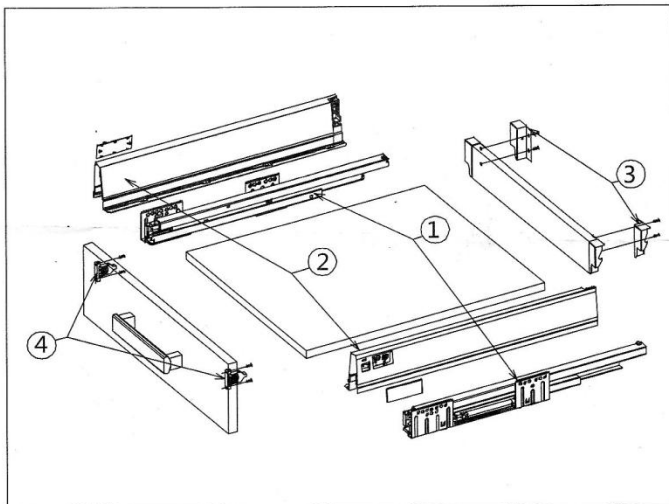

Runner Installation(mm)

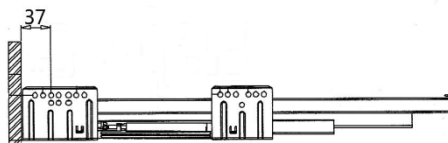

Basic length:270/350/400/450/500

Inside Cabinet Dimension

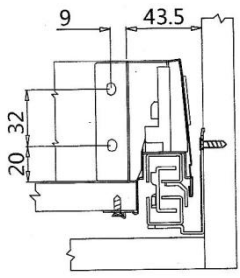

Front Panel Mounting Positions

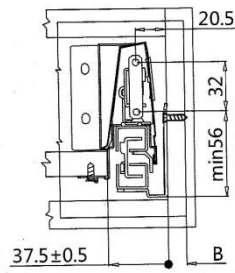

B Side Overlay (user defined)

Front Panel Brackets Positions

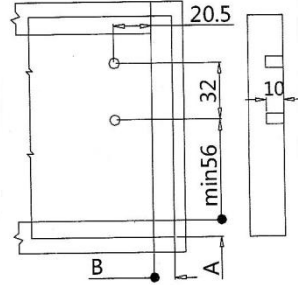

AB Side overlay(user defined)

Back Panel Mounting Positions

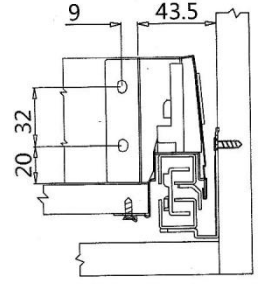

Front Fixing Brackets Mounting

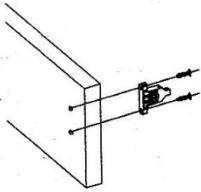

1 Installed panel
Remember that tighten the fixing screw

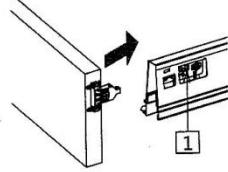

1 Loosen the fastening screws
2 Rotation to dismantle the panel

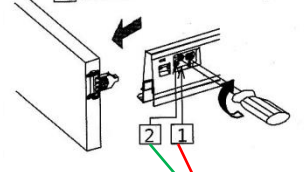

Front Panel Height Adjustment: +/- 2mm

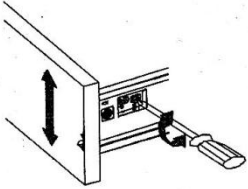

Front Panel side adjustment: Right 1mm

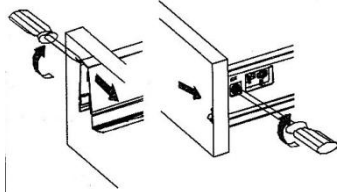

Front Panel side adjustment: Left 1mm

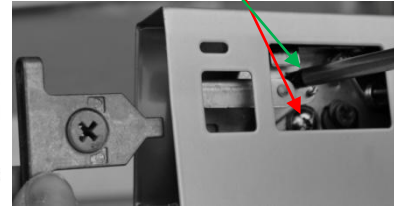
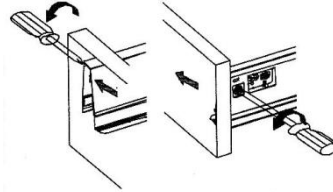

Mounting the Drawer

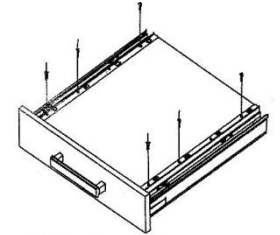
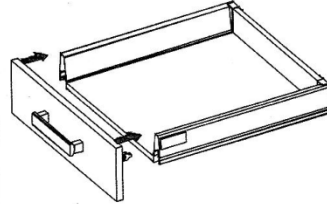
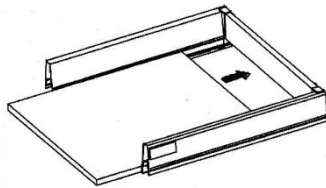
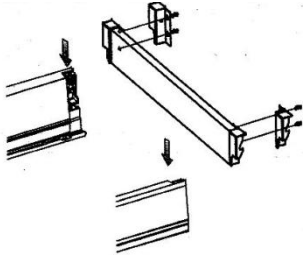

Installing the Drawer

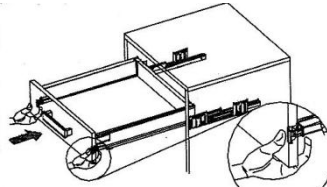
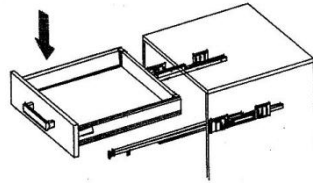
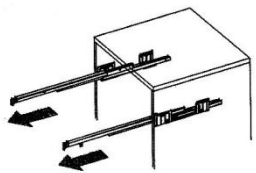

Push drawer into cabinet, then pull out the drawer, pull the plastic buckle into the metal strapnet.

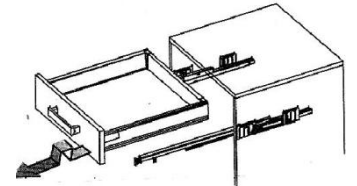

Function of the Damper

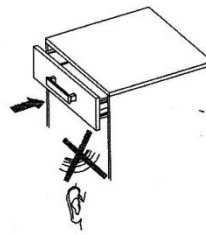
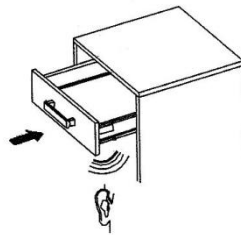
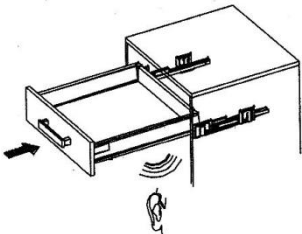

DBT Soft Close System Appendix **Pan Assembly Instructions**

Single Rail

Single Rail Pan requires 'Clip A' (*pre installed to rail*)

Double Rail

Double Rail Pan requires 'Clip A' & 'Clip B'
(*Unscrew clip A from the rail and screw Clip B to the rail*)

Acrylic Sides

Acrylic holders clip onto the acrylic sheets (*remove protective cover from acrylic before assembly*)

Fixing to Drawer Fascia

Slide back the plastic cover from rail, Remove end fixing cap, and fix to drawer fascia, secure rail into end fixing cap and slide plastic cover to secure

Corner Post Release

The corner post release is shown in the photo

Internal Drawer Fascias

